

Room 3's Birthday Party Layout

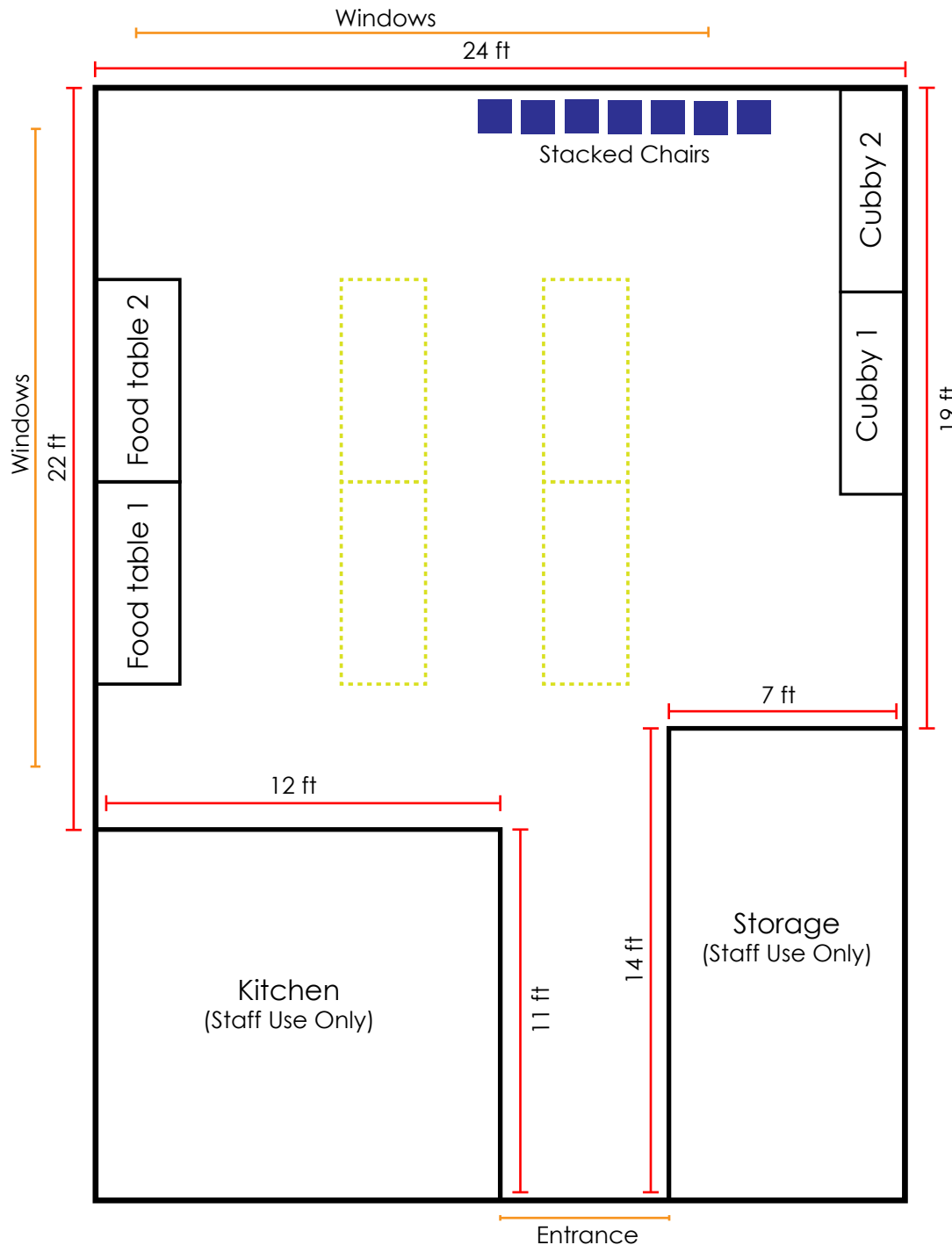

- Room 3 has a maximum of 30 children and 50 in total including parents.
- Numbers of table should be dependant on the number of children of each party.
- Furnitures must NOT be moved to ensure the safety of others and to maintain the longevity.
- Table size 6ft x 2.5ft
- Chair size 18in x 18in
- Room scaled 200%

